

Length	Size A(mm)	Size B(mm)/Size C(mm)
600mm	620mm	75
1200mm	1152mm	75
1500mm	1452mm	75

Wiring Method:

- Single wired



- Linkable (Double wired)



How many LED fixtures we could connect on one line

	Input Voltage	Max Qty
1.5mm ²	230VAC/20W	54
	230VAC/39W	36
	230VAC/50W	27

take out old cap then install the waterproof end cap

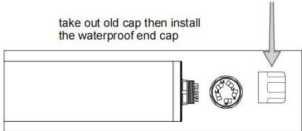

Ceiling mounted:

Make a right position and screw hole on Ceiling
Fix the clip into ceiling

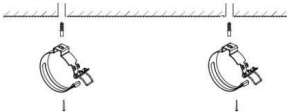

Install the lamp into the clips.

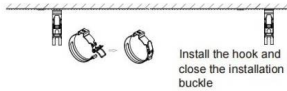

Fixed the light



Installing split pins with hand



Suspension with steel cable:

Make a right position and fix the clip

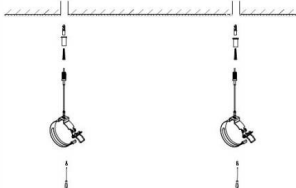

Install the lamp into the clips.
Install the hook and close the installation buckle.
Then adjust the length of suspension kits.

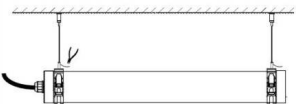

Installing split pins with hand



Connecting Power Supply:

• Single wired

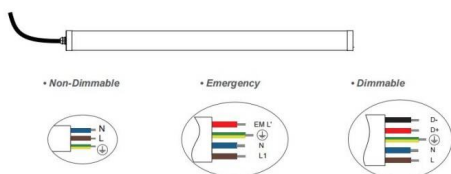

Connecting Power Supply:

• Linkable (Double wired)

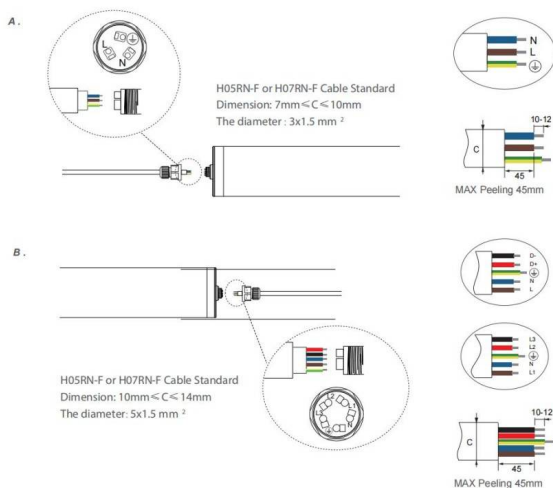

Accessory:

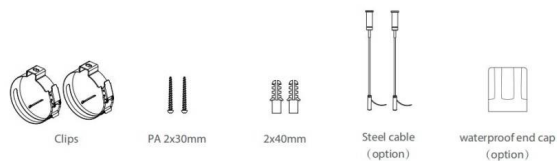

Tools:

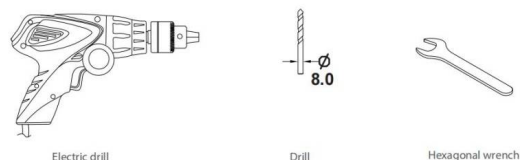

Safety notes:

The installation and connection of the luminaire must be done when power switched off and by qualified people.

Make sure no electrical power during installation.

Max current should not exceed 16A in one power feed in circuit.

The light source contained in this luminaire shall only be replaced by the manufacturer or his service agent or a similar qualified person.

D This product contains a light source of energy efficiency class D.